



Board of Commissioners Work Session Agenda
January 8, 2020 ~ 10:00am ~ Room 214

1. **Call To Order & Those Present**
2. **Approve Minutes From Last Meeting**
3. **Sarah Miller - Klamath Tribal Enrolled, Descendant And/Or Tribal Affiliated Members Partnership With Mental Health And Addictions Association Of Oregon**
4. **Jesse Withers**
5. **BOCC**

1. **In The Matter Of Designating The Property Located At 14040 Sprague River Road, Chiloquin, Oregon To The Public Works Dept. For Future Use. - Tax Collector/Property Manager Rick Vaughn**

Background: Klamath County obtained the above-named property through foreclosure due to non-payment of County taxes in 2018. On December 18, 2019 at the County Counsel Work Session meeting the Klamath County Board of Commissioners agreed to designate the above named property to the Public Works Department for future use.

Fiscal Impact: None at this time.

Recommended Motion: Approve and sign the attached Resolution designating the property located at 14040 Sprague River Road, Chiloquin, Oregon, map number: R-3509-01100-00500-000 to the Klamath County Public Works Department for future use. There is no fiscal impact.

Documents:



01-07-20-TAX-RE2020-010 DESIGNATE 14040 SPRAGUE RIVER
RD TO PUBLIC WORKS.PDF

2. Counsel Engagement Letter

6. Other County Business

1. Review And Authorize Chair To Sign Title III Certification Letters

7. Adjournment

Audio recordings of all proceedings are available at the County Commissioners' office. The meeting facility is handicap accessible. Persons needing materials in alternate format or communication access, should telephone this office at 541-883-5100  (voice/TDD) or the ADA Coordinator at 541-883-4296  at least 48 hours in advance of the scheduled meeting.

Klamath County Commissioners' Weekly Calendar is subject to change without notice.
305 Main Street 2nd Floor, Klamath Falls, OR 97601

E-mail: bocc@klamathcounty.org Website: www.klamathcounty.org



BOARD OF COMMISSIONERS
Agenda Item Summary

Agenda Category:	RESOLUTION	Item No:
		RE2020-

Meeting Date: January 7, 2020

Originating Department: Property Sales

Issue: In the matter of designating the property located at 14040 Sprague River Road, Chiloquin, Oregon to the Public Works Department for future use.

Background: Klamath County obtained the above named property through foreclosure due to non-payment of County taxes in 2018. On December 18, 2019 at the County Counsel Work Session meeting the Klamath County Board of Commissioners agreed to designate the above named property to the Public Works Department for future use.

Fiscal Impact: None at this time.

Recommended Motion: Approve and sign the attached Resolution designating the property located at 14040 Sprague River Road, Chiloquin, Oregon, map number: R-3509-01100-00500-000 to the Klamath County Public Works Department for future use. There is no fiscal impact.

DONE AND DATED 7th day of January, 2020.

Chair

Approved
Denied

Vice-Chair

Approved
Denied

Commissioner

Approved
Denied

**BOARD OF COUNTY COMMISSIONERS
KLAMATH COUNTY, OREGON**

IN THE MATTER OF DESIGNATING THE) RESOLUTION 2020-_____
PROPERTY LOCATED AT 14040 SPRAGUE)
RIVER ROAD, CHILOQUIN, OREGON)
TO THE KLAMATH COUNTY)
PUBLIC WORKS DEPARTMENT)

WHEREAS, Klamath County obtained the above-named property through foreclosure due to non-payment of County taxes in 2018;

WHEREAS, on December 18, 2019 at the County Counsel Work Session meeting, the Klamath County Board of Commissioners agreed to designate the above-named property to the Public Works Department for future use.

NOW, THEREFORE, BE IT RESOLVED, that the Klamath County Board of Commissioners designates the property located at 14040 Sprague River Road, Chiloquin, Oregon map number: R-3509-01100-00500-000 to the Klamath County Public Works Department for future use.

DONE AND DATED this 7th day of January, 2020.

KLAMATH COUNTY BOARD OF COMMISSIONERS

Chair

Vice-Chair

Commissioner



Klamath County Taxlot Finder



Imagery



Imagery with Labels



Streets



Topographic



KLAMATH COUNTY

Taxmap Link	More info
Info Date	12/14/2019
PROP ID	252504
MTL	3509-01100-00500
OWNER	KLAMATH COUNTY
OWN ADD1	
OWN ADD2	C/O PROPERTY SALES
OWN ADD3	305 MAIN ST #RM 121
OWNER CSZ	KLAMATH FALLS, OR 97601
SITE ADDRESS	0000 UNKNOWN
SITE City State	KLAMATH FALLS,
Zoom to	

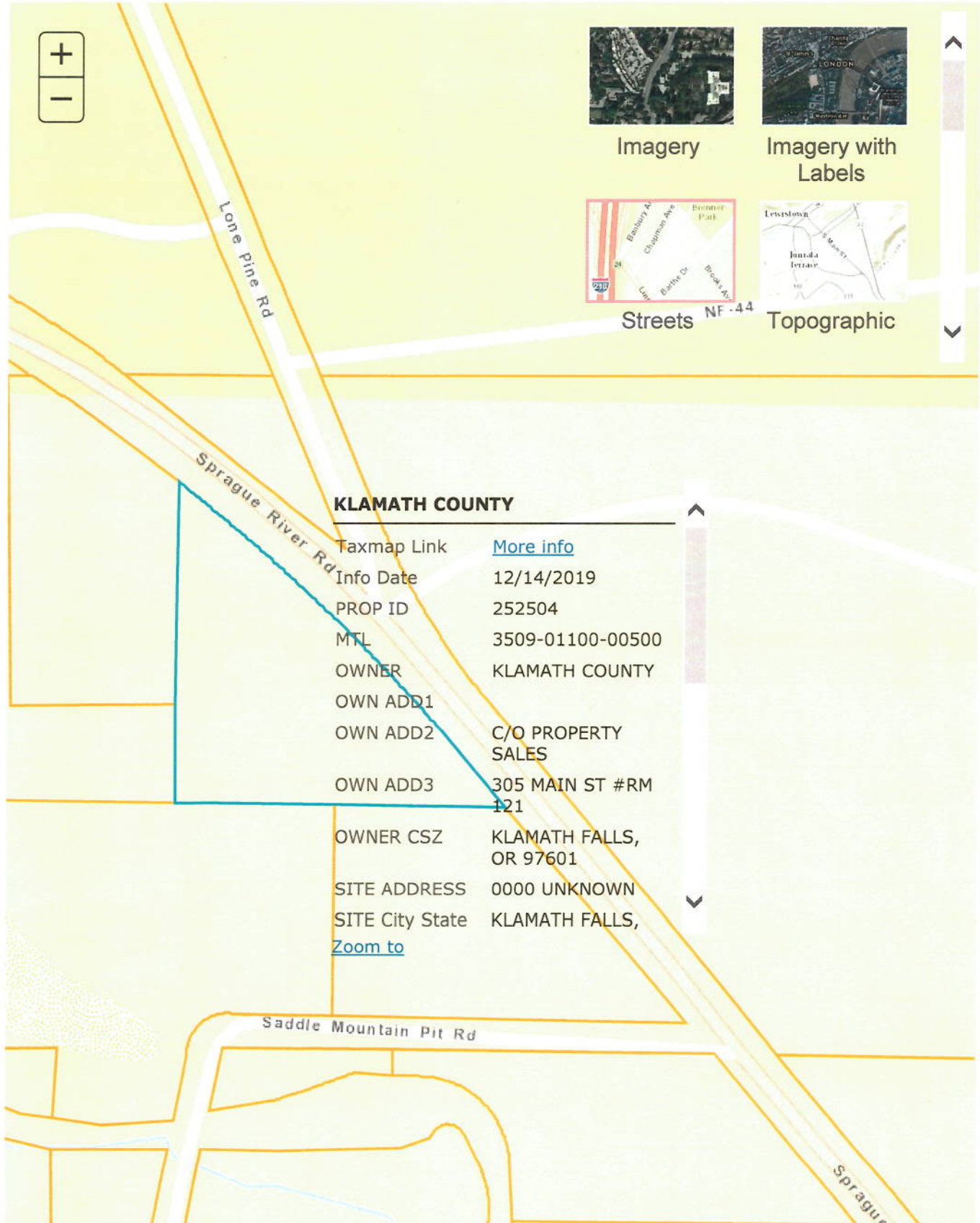



Klamath County Taxlot Finder

